

The logo for ONEhalf20, featuring the company name in a stylized, bold font with a horizontal line through the middle of the letters.

Model RD9H Extruder Rupture Disk with 1/2 - 20UNF - 2A Mounting Thread

Product Introduction

ONEhalf20's Model RD9H Extruder Rupture Disk is designed for emergency relief of excess pressure in plastics processing machinery. It is designed to instantaneously rupture at a predetermined pressure. The Model RD9H Extruder Rupture Disk is available in a variety of burst pressures.

The Model RD9H may be specified for primary relief in applications where pressure build-up can occur so rapidly that the response time of a relief valve is inadequate.

Features & Benefits

- burst pressures from 1,500 to 15,000 psi
- 1/2-20 UNF mounting thread
- SS or Inconel disk
- suitable for melt temperatures up to 825°F
- burst pressure accuracy +/- 5%
- low installation and maintenance cost
- all stainless steel body

Model RD9H Photo



Ordering Guide

<u>Model Number</u>	<u>Length & Installation</u>
RD9H	9.0" with hex head

Standard Rated Burst Pressures

-1.5M	1,500 psi
-2.5M	2,500 psi
-3.5M	3,500 psi
-4.5M	4,500 psi
-5.5M	5,500 psi
-6.5M	6,500 psi
-7.5M	7,500 psi
-8.5M	8,500 psi
-9.5M	9,500 psi
-10.5M	10,500 psi
-12.5M	12,500 psi
-15M	15,000 psi

Model RD9H with 1/4NPT Photo



Note:

For burst pressures not listed please consult your **ONEhalf20** distributor.

<u>Option</u>	<u>Description</u>
1/4NPT	1/4" discharge connection

North America Toll Free 877 781-1881
Other Locations 905 474-5650
www.onehalf20.com

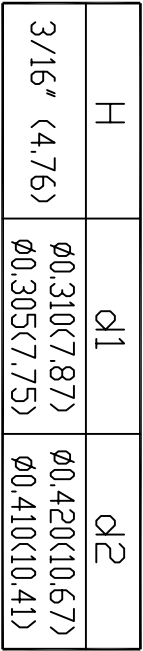
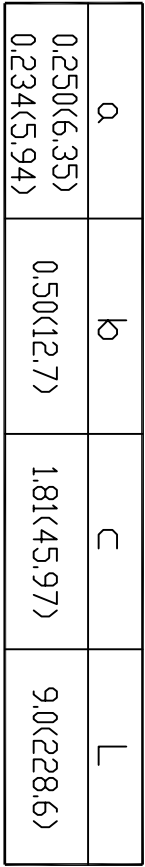

DETAIL A

DATE: August/2006 V2.1

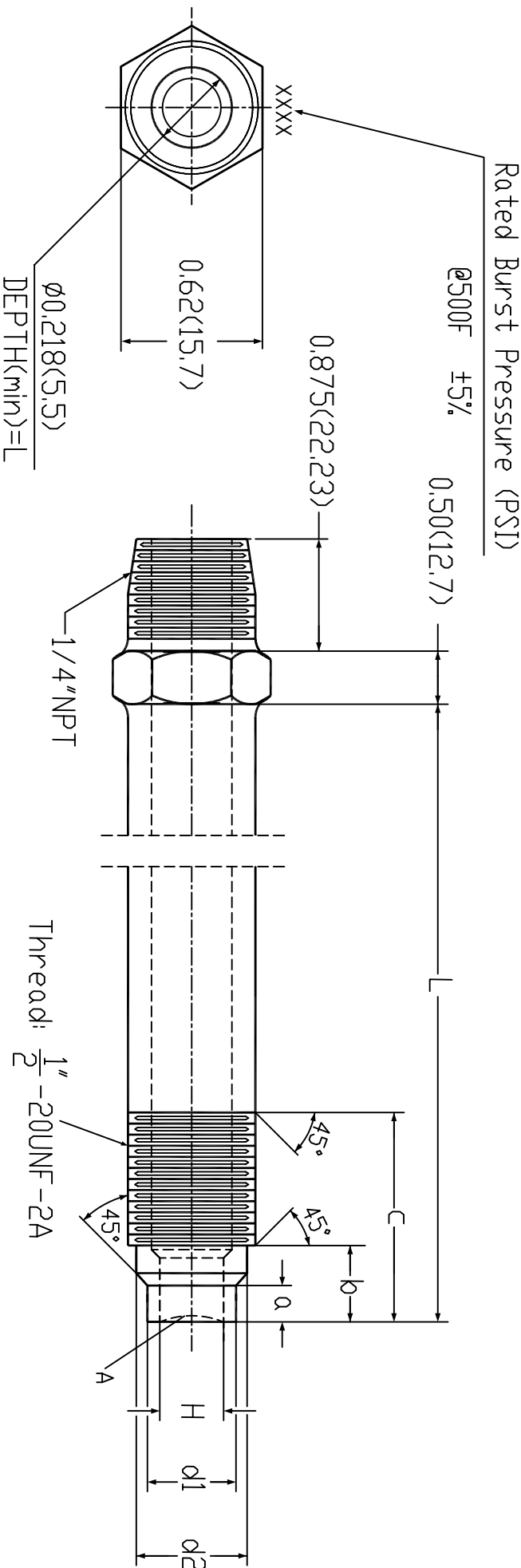

a	b	c	L
0.250(6.35) 0.234(5.94)	0.50(12.7)	1.81(45.97)	9.0(228.6)

H	d1	d2
3/16" (4.76)	$\varnothing 0.310(7.87)$ $\varnothing 0.305(7.75)$	$\varnothing 0.420(10.67)$ $\varnothing 0.410(10.41)$

$H = \frac{3}{16}$ DIA.